



### BUILT

Year	:	June 2009
Builder	:	Grandweld, Dubai - U.A.E
Class	:	ABS, +A1 HSC + AMS
Flag	:	ST. Vincent, Kingstown
IMO No	:	9544671
Call Sign	:	J8B 4074

### PERFORMANCE

Speed (Max)	:	19 Knots
Speed: (Cruising)	:	16 Knots
Consumption	:	125 USG/H
Deck Space	:	120 M2
Deck Load	:	50 tonnes
Deck loading at stern	:	2 ton/M <sup>2</sup>
Deck Cargo	:	30 MT

### DIMENSIONS

LENGTH (OVERALL)	:	41.00 M
BREADTH (MOULDED)	:	7.30 M
DEPTH (AT MIDSHIP)	:	3.50 M
DRAFT LOADED	:	1.75 M
GROSS TONNAGE	:	242
NET TONNAGE	:	72

### CAPACITIES

FUEL OIL	:	15000 USG
FRESH WATER	:	10000 USG
LUBE OIL	:	300 USG
HYD. OIL	:	50 USG
BLACK WATER	:	300 USG
GREY WATER	:	300 USG
FOAM	:	100 USG
DISPERSANT	:	100 USG

### PROPULSION - MACHINERY

Main Engines	:	3 x CAT, Model C32
Output / rpm	:	4000 BHP @ 2100 RPM
Gear Boxes	:	Twin disc MGX 6650 2.93:1 Ratio
Engine Control	:	ZF Pneumatic Control
Fixed Pitch Propellers:	:	3 x Five Blade, Ni-Al-BR
Aux. Generator Sets	:	2 x 84 CAT Gen Set C4.4 380V 50HZ 3 Ph
<b>STEERING SYSTEM</b>	:	Kobelt -Hydraulic
<b>BOW THRUSTER</b>	:	1x 75HP, thrust 1.6Tons

### ACCOMMODATION

(Central Air-Conditioning System)		
Accommodation	:	9Crew + 7Passenger in Cabin
Offshore Personnel	:	28 seats remaining

### DECK EQUIPMENT

Anchor Capstan	:	1 x HYPAC HHAW 15 - 16
Anchor	:	1 x Fortress Anchor
Fendering	:	Alum Pipe "D" Fender + Tyres
Deck Crane	:	2 Tons, Model P15000 L/4SI

### AUXILLIARY MACHINERIES & OTHER EQUIPMENT

OILY WATER SEPARATOR	:	1 x 0.5 M <sup>3</sup> /H X 15 PPM
FUEL OIL PURIFIER	:	1 x 1150 LTR/HR
FW & SW HYDROPHORE	:	2 x 100 Ltr Tk With 2 Pumps 3 M <sup>3</sup> /H X 30 M - <b>AZCUE PUMP</b>
WATER HEATER	:	1 x 200 LTR CAPACITY
FIRE & GS PUMP	:	1 x 30 M <sup>3</sup> /H X 40 M - <b>AZCUE PUMP</b>
STARTING AIR COMPRESSOR	:	1 x 3 M <sup>3</sup> /H X 30 BAR - NK 2 x 355 Ltr Air Receiver - NK
Bilge Pump	:	1 x 30 M <sup>3</sup> /H X 30 M - Azcue Pump
FW Transfer Pump	:	1 x 25 M <sup>3</sup> /H X 30 M, - Azcue Pump
Sewage Pump	:	1 x 1 M <sup>3</sup> /H X 15 M - <b>AZCUE PUMP</b>
SLUDGE PUMP	:	1 x 2 M <sup>3</sup> /H X 30 M - Azcue Pump
Emergency Fire Pump	:	1 x 30 M <sup>3</sup> /H X 38 M DIESEL ENGINE DRIVEN
SEWAGE TREATMENT PLANT	:	1 x 1960 LTRS / DAY
FUEL OIL TRANSFER PUMP	:	21 x 6 M <sup>3</sup> /H X 20 M - <b>AZCUE PUMP</b>
FRESH WATER CARGO PUMP	:	1 x 25 M <sup>3</sup> /H X 35 M - <b>AZCUE PUMP</b>
Fuel Oil & FW Flow Meter	:	1 Each
FUEL OIL CARGO PUMP	:	1 x 25 M <sup>3</sup> /H X 25 M - <b>AZCUE PUMP</b>

### ELECTRONICS / NAVIGATION EQUIPMENT

RADAR	:	2 x RADAR KODEN, 48 NM,
ECHO SOUNDER	:	1 x JMC JAPAN, V-6202
GYRO COMPASS	:	1 x YOKOGAWA, CMZ 700B
AUTO PILOT	:	1 x COMNAV, COMPILOT COMMANDER H480426
MAGNETIC COMPASS	:	1 x DIRIGO
DGPS	:	1 x KODEN, KGP 913D
EPIRB	:	1 x ACR, RLB-32, SAT2, 406 CAT1
VHF Radio	:	2 x VHF RT2048, SAILOR
SSB Radio	:	STR 6000A DSC VHF- SRG1150 DN MF/HF/DSC
SART TRANSPONDER	:	ACR, USA
Walkie Talkie	:	3 x Standard Japan Model HX370
PUBLIC ADDRESS SYSTEM	:	1 x PHONTECH – NORWAY CIS3100
ELECTRIC HORN	:	1 x ELECTRIC HORN
NAVTEX RECEIVER	:	1 x SAMYUNG KOREO, SNX 300
Wind Speed Indicator	:	1 x Vetus Holland, WSD 834

### SAFETY EQUIPMENT

Rescue Boat with Davit for 7 Person	:	
FiFi	:	1200 M3/Hr with One monitor

### SAFETY EQUIPMENT IN ACCORDANCE WITH SOLAS AND FLAG REQUIREMENT

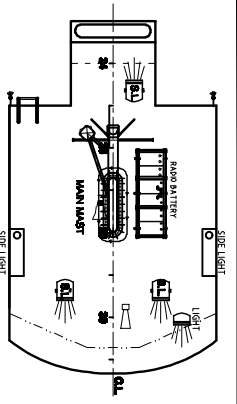

WHEEL HOUSE TOP

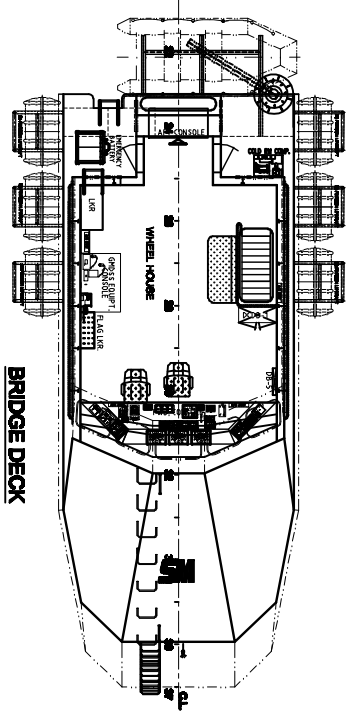

BRIDGE DECK

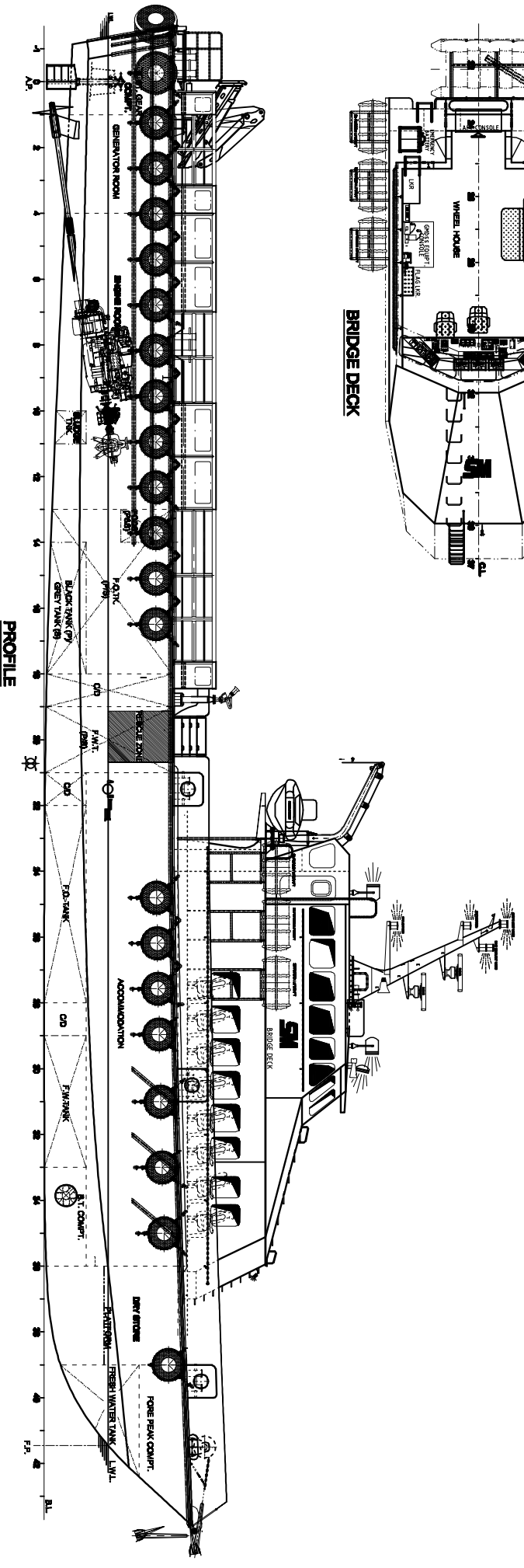

PROFILE

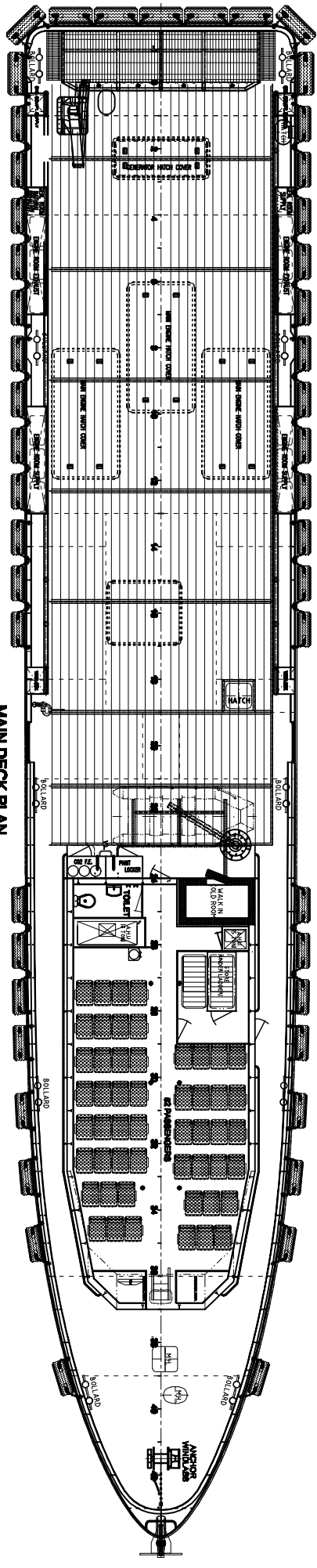

MAIN DECK PLAN

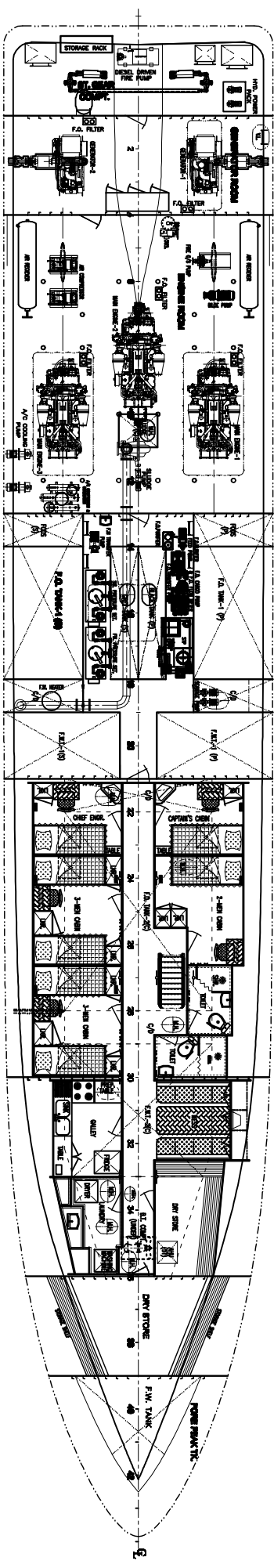

BELOW DECK PLAN

MAIN PARTICULARS	
LENGTH OVERALL	41.00 M.
L.B.P.	37.30 M.
BREADTH	7.30 M.
DEPTH	3.30 M.
DRAFT, HULL	1.75 M.
HULL	ALUMINIUM
DECK AREA	125 M <sup>2</sup>
DECK STRENGTH	2 T/SQM
DECKLOADS	30 TONS
CREW	8
VIP PERSONNEL	2
SEATING CAPACITY	52
MAIN ENGINES	3 X CATERSPIRAR C 32 HEAVY DUTY RATING DEVELOPING 1400 BHP @ 2000RPM
GENERATORS	2 X CATERSPIRAR CH4 85 KW @ 1500RPM 380V, 50 HZ, 3PH.
BOW THRUSTER	1 X 75HP @ 1500RPM KEY POWER BOW THRUSTER IP - 18
CAPACITIES:	
FUEL OIL	6000 LITRES (15,673 USG)
FRESH WATER	4400 LITRES (11,623 USG)
LUB OIL	500 LITRES (132 USG)
HYDRAULIC OIL	100 LITRES (27 USG)
DIRTY WATER SEPARATION TANK	500 LITRES (132 USG)
BLACK AND GREY WATER	2500 LITRES (661 USG)

AS FITTED

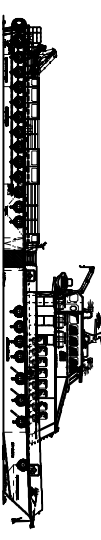

**GRAND WELD**

SPRINTACUMARE SERVICE/CONSTRUCTION/STEERING AND MANEUVERING SHIP  
FABRIK 2478 DORN UAL/13-16000 DONG DAI/26-2020/2016/2014/16

**41M ALUMINIUM CREW BOAT**  
(GRANDWELD TYPE)

GENERAL ARRANGEMENT

NO.	REVISIONS	DATE	BY	CHKD.	APPV.	REASON
01	AS FITTED					

DRAWN BY : SAHIL  
 CHECKED BY : SILLUK  
 APPROVED BY : OIL  
 DATE : 08/08/2014  
 CLIENT : STANFORD MARINE, LLC.

THIS DRAWING IS THE PROPERTY OF GRAND WELD. IT IS TO BE USED ONLY FOR THE PROJECT AND VESSEL SPECIFIED HEREIN. ANY REUSE OR MODIFICATION WITHOUT WRITTEN PERMISSION IS STRICTLY PROHIBITED.